



# LED T8 4ft Tube Open Commercial Light Fixture

LEDSTR100-1-4LR



48" Open Lamp – One-Light Strip Channel — Premium-Grade for LED T8 Light Tube(s) — ETL Listed

## FEATURES

- **Fixture Warranty:** 2 Years
- 1-Lamp Strip for LED T8 Light Tube
- Heavy-Duty On/Off Safety Switch
- **Housing:** 22-Gauge, Cold-Rolled Steel
- **End Plates:** Fastened to Housing by Sheet Metal Screws to Assure Rigidity; May Be Used as Channel Couplings
- **Door Frame:** 22-Gauge Cold-Rolled Steel; Painted after Fabrication
- Screw-On End Caps
- **Finish:** Baked White Polyester
- **Safety Assurance:** ETL Listed / Conforms to UL Standard 1598 - SUB 8750



ONLY FIXTURE IS SOLD – 4-ft. LED T8 LAMP SOLD SEPARATELY.

Never Install Fluorescent Tubes in These Fixtures.

## SPECIFICATIONS

SPECIFICATIONS SUBJECT TO CHANGE WITHOUT NOTICE

<b>PART NUMBER</b>	LEDSTR100-1-4LR
<b>Type</b>	Open Lamp One-Light Channel for LED T8 Light Tube(s)
<b>Door Frame</b>	22-gauge cold-rolled steel; T-hinge, positive-spring-loaded latch
<b>Construction</b>	22-gauge cold-rolled steel housing
<b>Finish</b>	Baked white polyester finish / Minimum Reflectance: 86%
<b>Wiring</b>	Operates T8 LED light tube(s) only
<b>Labels</b>	ETL-Listed / Conforms to UL Standard 1598-SUB8750
<b>Lamp Type</b>	LED T8 light tube, self-driven Both black and white leads connected to the same end

## SAFETY SWITCH



TS-2 LED LUMINAIRE ON/OFF SAFETY SWITCH

- Easily accessible on exterior of wire way

- Allows individual fixture to be switched ON/OFF during re-lamping or Maintenance
- Prevents damage to lamp and electrical shock during lamping and re-lamping
- Allows safe entry to wire way channel where power connector can be disconnected for maintenance to fixture

### CROSS SECTION

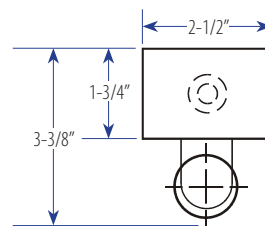

### BACK PLATE

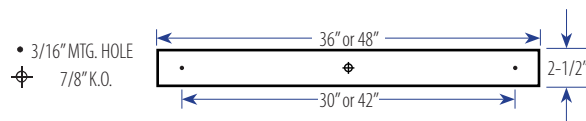

Available for the T-Bar Luminaire (NOT INCLUDED)

## White LED T8 Tubelight / 4 Ft

Series LED48T8SM



Long-Life, Energy-Efficient Drop-In Fluorescent Replacement Tubes in 2-Pin/G13 Base

Clear Lens – 3000K or 4100K or 5200K White – Consumes 18 Watts Premium SMD LEDs Operates on 90-to-290VAC

LEDTRONICS®  
Creating the Future of Light Since 1983™

© 2012 LEDtronics, Inc.



23105 Kashiwa Court, Torrance, CA 90505  
Phone: (800) 579.4875 / (310) 534.1505  
Fax: (310) 534.1424  
E-mail: info@ledtronics.com  
Website: ledtronics.com

www.LEDtronics.com

LOG 327 / Rev 07 -2012

Check LEDTRONICS.COM for latest data. Printed material may be outdated.